

MICROFILMED

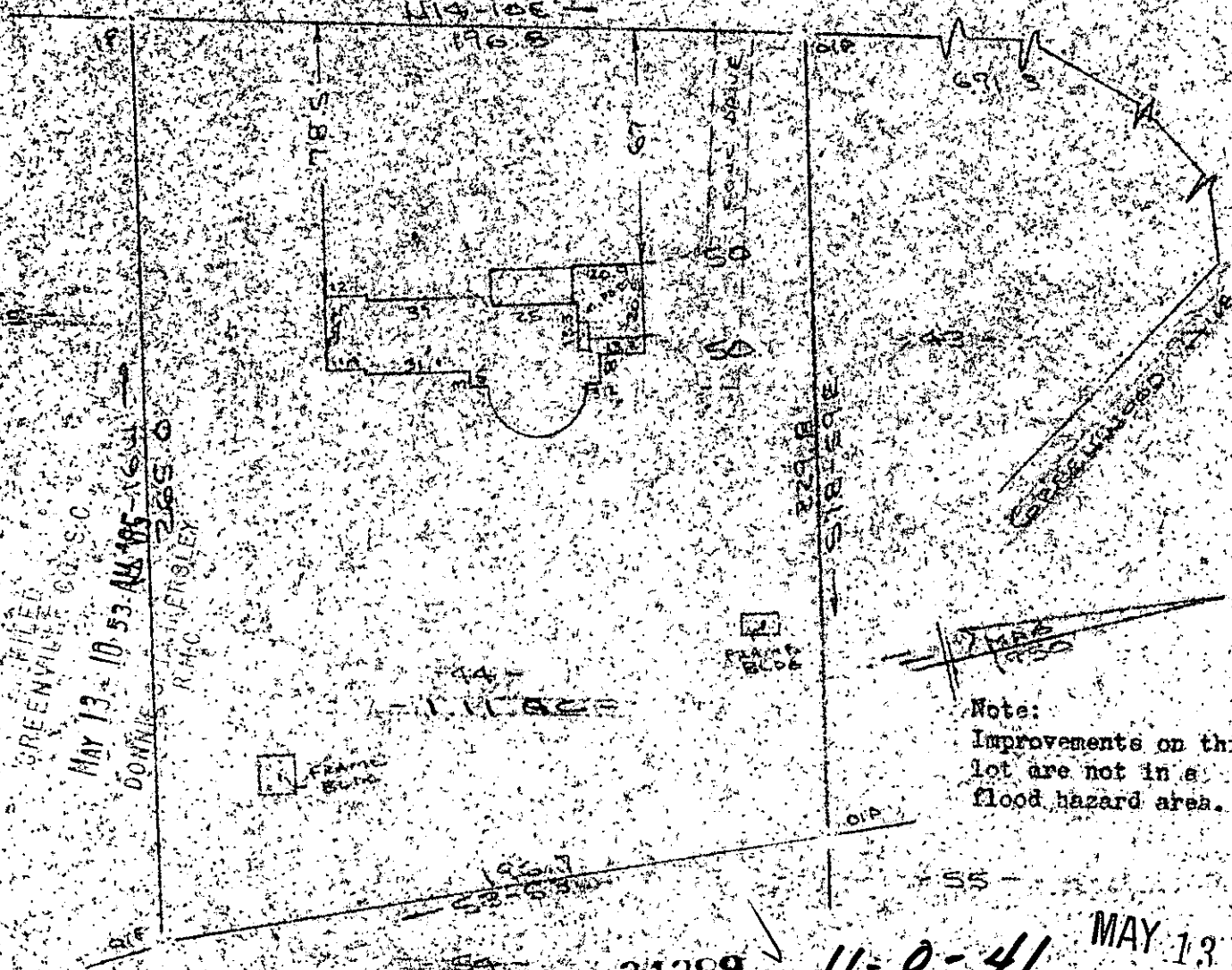

GREENVILLE CO. S.C.
 MAY 13 10 53 AM '85
 DOWNS
 R.M.C. FRISLEY

Note:
 Improvements on this
 lot are not in a
 flood hazard area.

PROPERTY OF
 JOHN D. CROCKE & PATRICIA F. CROCKE
 NEAR GREENVILLE, SOUTH CAROLINA
 SCALE 1" = 50' MAY 1985

This is to certify that on the 8th day of May, 1985, I surveyed the property shown on this plat, being known as lot 44 (1.11 acres) on plat 42 HUDSON ACRES and recorded in the REC-Office Greenville County, S. C., in Plat Book "Y" at Page 59; and that the property lines, walls and buildings are as shown hereon, and that the walls and buildings located on said lot do not encroach or project on adjacent street or property, and that no adjacent walls or buildings encroach or project on said premises, and no power lines cross this property except as shown hereon. Also known as PROPERTY OF JOHN D. CROCKE & PATRICIA F. CROCKE and recorded in Plat Book 58 Page 59.

R. B. Bruce
 R. B. Bruce, RLS 1953

7901221000